



MIDCOAST
council

Gloucester Community Garden

December 2020

Engagement Outcomes Report

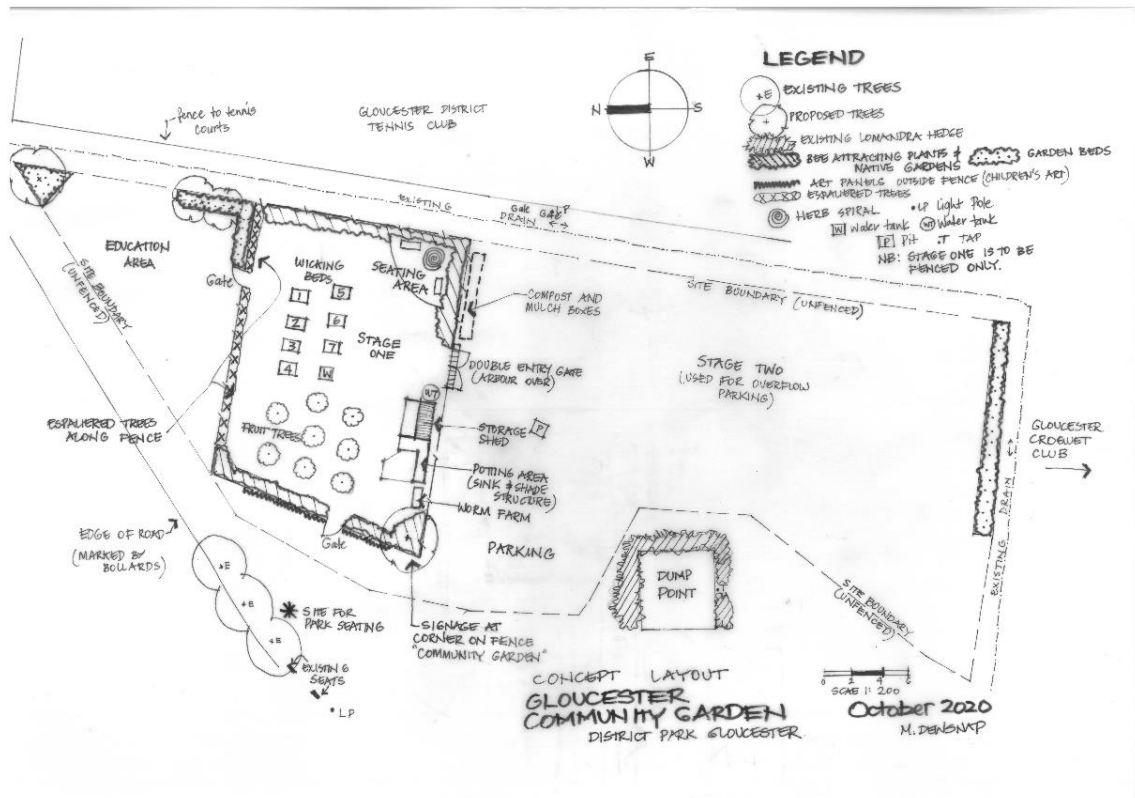

Introduction

This report provides a summary of community consultation that was undertaken from 26 October to 4 December 2020 to gain community feedback on the proposal for a community garden located at Boundary Street Gloucester Lot 1 DP 842441 within Gloucester District Park.

This report is presented in nine sections:

1. Introduction and background
2. What we engaged the community on
3. How people had their say
4. What people told us
5. Submissions
6. Additional information
7. Summary
8. Next steps
9. Appendices

Project background

An independent community group was established in Gloucester to develop a community-based garden that will produce fruit, vegetables and herbs as well as other plants grown to organic standards. The garden is aimed at promoting an opportunity to share knowledge and skills in gardening techniques and practices while encouraging social networking and community inclusion. Raised wicking beds will be installed to save water and provide access for elderly and disabled people.

The Gloucester Community Garden (GCG) aims to have a social focus while demonstrating good sustainable gardening examples that people can use in their own gardens. It is intended for the produce grown to be shared communally. The manageable size of the lot will help encourage social mixing and active involvement which is a cornerstone of the education that comes with working alongside knowledgeable gardeners.

Council has donated land at Boundary Street Gloucester Lot 1 DP 842441 (Gloucester District Park). This proposed site is adjacent to the north western tennis court boundary fence, with stage 1 approximately 500m².

GCG will focus on actively developing the garden to create a healthy, economically vibrant and safe neighbourhood with a visually appealing location with attractive garden design and plantings, artworks created by young children in our community, and an inviting space for individuals and groups to enjoy together.

The intent is not to sell the produce with members being able to benefit from the produce with excess being donated to organisations that support individuals in need such as; the Bucketts Way Neighbourhood Group, Food With Friends, Westpac Helicopter via the Health Food Store and others where possible.

The GCG will serve around 50 gardeners, across all ages, income ranges, and levels of experience. It is proposed that people can join the GCG by paying an annual membership fee and become involved by attending gardening instruction sessions, and Site Safety Induction by MidCoast Council's Volunteer Instructor.

Ongoing funding will be achieved with membership fees, grants, fundraising activities and sponsorship. Future opportunities for revenue generation may be achieved through gardening classes, community events and tourist visits.

What were people engaged on?

Purpose of engagement

The overall purpose of the engagement with the community was:

- Inform the community of the proposed community garden
- Understand whether community support the project
- Seek feedback on the community garden concept and location
- Ensure the concept design is reflective of the communities needs and desires
- Provide community with an opportunity to understand the community garden elements and provide informed feedback
- Educate community on how their feedback is used to inform decisions
- Continue to build relationships and trust in Council's decision-making process

Objectives of engagement

To achieve this, the engagement had the following objectives:

- To educate the community and key stakeholders on the considerations given to the proposed community garden and location
- Ensure participants in the engagement feel their feedback is valued during this process and are informed of the how their feedback will be used to inform project outcomes
- Provide key stakeholders and community with the opportunity to complete the online survey and share their opinions/suggestions
- To continue to build trust with our community and ensure that we deliver benefits by meeting the current and future needs of the community



Project scope

- This is a community led project and council will contribute by way of work in kind, access to water and provision of taps
- Council has donated land at Boundary Street Gloucester Lot 1DP 842441 (Gloucester District Park). This proposed site is adjacent to the north western tennis court boundary fence, with stage 1 approximately 500m2.
- Proposed community garden to include:
 - Picnic table and chairs with shaded pergola
 - Garden shed
 - Raised garden beds “wicking beds”, own soil and watering system
 - Fruit trees - various
 - Vegetable gardens
 - Fencing
 - Education and learning area
 - Polypipe shade house

Proposed community garden will be delivered and maintained by community garden group members.

How did people have their say?

The range of engagement activities undertaken provided a variety of ways for the community to share their opinion, ideas and generate community conversations.

Face-to-face engagement	Online and electronic engagement	Communications
6 November – Drop-in session Gloucester Council Chambers	Have your say page on Council's website with 288 unique page views	Media coverage – radio News Wrap on <ul style="list-style-type: none"> ○ 30 October ○ 6 November ○ 13 November ○ 20 November ○ 27 November

26 November – Drop-in session Gloucester Council Chambers	130 online surveys completed	Media Release 26 October Advertisements in local papers Manning River Times and Gloucester on 28 October and 4, 11, 18, 25 and 2 December Great Lakes Advocate on 29 October and 5, 12, 19, 26 November and 3 December
14 November – Pop up at Gloucester Farmers Market		Submission
Zoom session x 2 cancelled due to low interest		2 submissions in total 1 email submission 1 paper submission
Direct contact to key stakeholder offering opportunity to discuss		

Engagement activities

The following activities were used to seek input and build awareness of the community garden consultation.

Have Your Say page

The *Have Your Say* page provided an online hub to both share information, encourage participation in engagement activities and direct linkage to the online survey.

Information included information on the project, community garden group and how to provide feedback or nominate to be a community garden volunteer.

Over the period of the engagement, there were **333** visits to this page.

Have your Say survey

This was the primary engagement tool to gain community feedback on the proposal for the Gloucester Community Garden. Participants were able to indicate if they supported a



community garden in Gloucester, the location and provide ideas and suggestions for the garden.

130 surveys were completed.

Appendix 1 provides a copy of the submission data.

Level of engagement

As outlined in MidCoast Council’s Community Engagement Policy we utilise the International Association for Public Participation (IAP2) five-point framework for measuring the level of community engagement for each project.

Within this scale, this project achieved an Inform /Consult /Involve level of engagement. At this level our commitment to the community was to listen to and acknowledge the naming preferences and any suggestions provided

The diagram below shows the levels of engagement and the activities undertaken within each level.

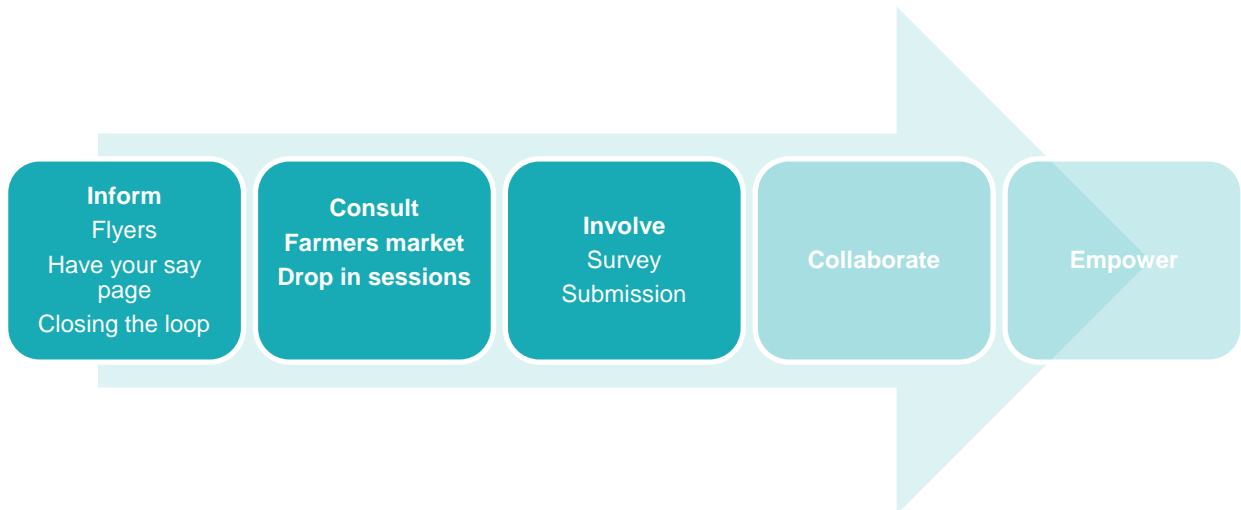

What people said?

Participants in the engagement were asked to provide feedback on the whether they supported a community garden in Gloucester and the proposed location.

130 surveys were completed with 118 stating that they support Gloucester having a community garden.

From the 130 surveys completed 96 responses supported the proposed location of Boundary Street Gloucester Lot 1 DP 842441 within Gloucester District Park, with 34 not in support of the proposed location.



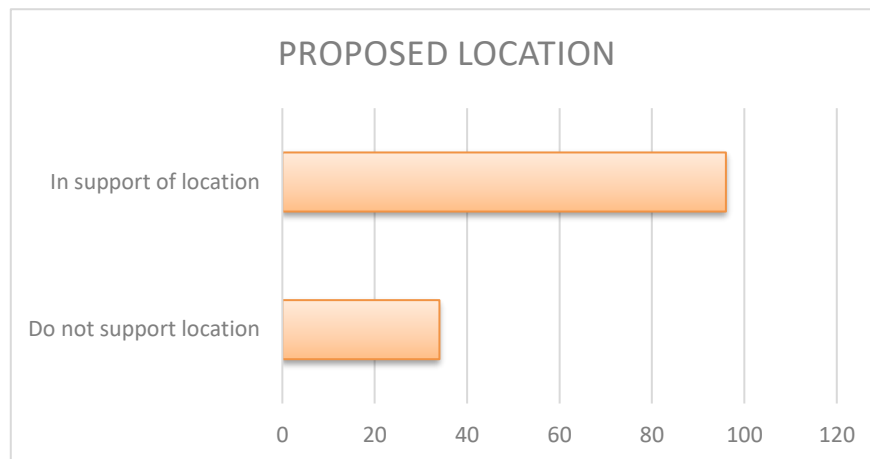

Figure 1.1 Survey results

Respondents were provided the opportunity to state why they did not support the proposed location. From the 36 responses not in support of the location six comments were received.

- “It will be an eye sore in a beautiful park when things start to die off especially in the middle of the playing fields why not down near the river out in the open just right for vandals and others to help themselves.”
- “This is a forced response. I need to know more about the site before giving a meaningful answer.”
- “The area allotted was supposed to be a sporting complex the area for the garden will take up car parking for tennis tournaments that bring a great deal of money to Gloucester and croquet tournaments also the swimming carnivals, I think the park in Ravenshaw Street would be a more suitable spot for it.”
- “I think they should be looking at the old Farley gates cricket field. It is too dangerous to play cricket there now. Take away the fence and make it into a car park and community garden. It would benefit Netball, Tennis, Soccer, Little Athletics and Rugby league with more car parks for when they have events.”
- “Too close to sewage collection point which can overflow and get stinky. Also too small an area for the community garden when people want to visit and park nearby when parking can be crowded by tennis, pool and croquet patrons.”
- “This is an under-utilized part of the park. Surely there is a better location. Not in such a public place.”

Two face to face sessions were held at the Gloucester Council chambers on Friday 6 and Thursday 26 November.

These sessions provided the opportunity for community members to meet members of the garden group, be provided with detailed information in relation to design and project scope



and enabled an open forum for constructive discussion on the proposed location, alternative locations, pros and cons, layout of site, materials being used and more. Participants were encouraged to put forward their thoughts and suggestions.

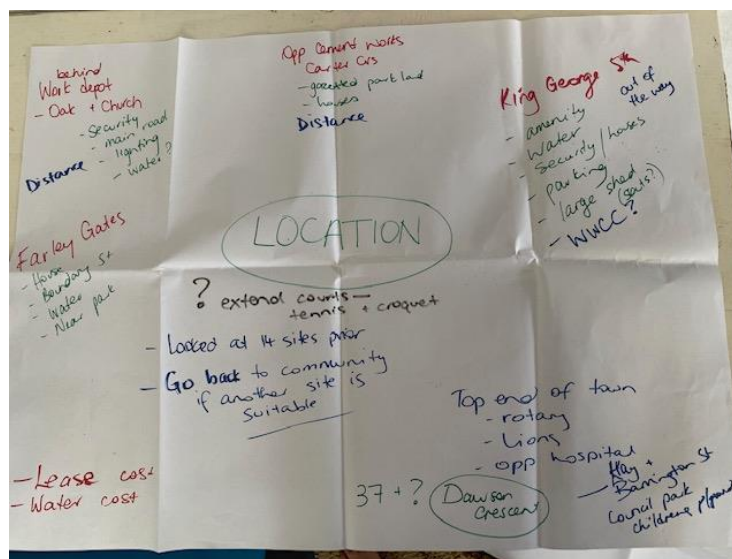
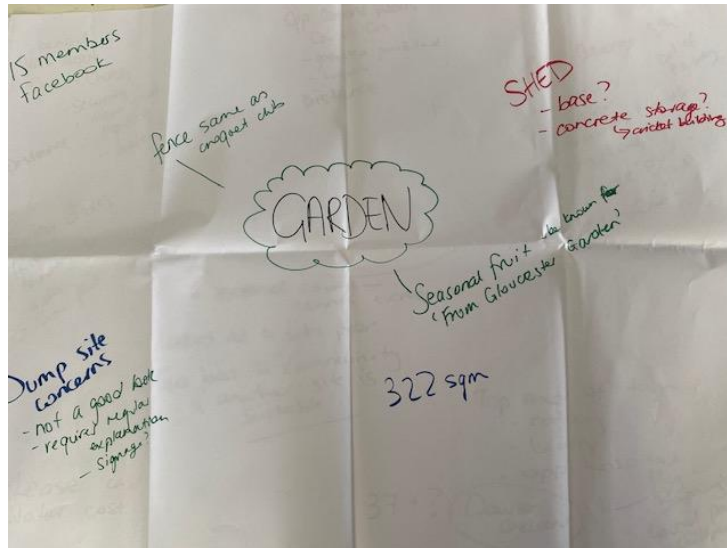

From discussions at our face to face sessions, farmers market and survey responses the following alternative locations were suggested:

Suggested location	Viability of location
Farley Gates cricket field	Not Viable

	Reason: Insufficient space. Impacts upon cricket and other active recreation.
Oak & Church Street (behind depot)	Not Viable Reason: Council does not own or manage the land.
Carter Crescent (opposite cement works)	Viable Reason: Council owned land and necessary open space available.
King George V	Not Viable Reason: Insufficient open space available (without the removal of vegetation).
Hay & Barrington Streets (opposite hospital)	Viable Reason: Council owned land and necessary open space available.

Submissions

1. During consultation the document attached at **Appendix 2** titled "Petition to MidCoast Council" was submitted. This document has signatures received between 5 August, 2020 to 16 October, 2020, prior to the community consultation period which was open from 26 October to 4 December 2020.
2. Email submission dated 3 November 2020 attached at **Appendix 3**.

Additional Information

Preliminary site investigations

The current site location was selected following extensive investigations by the Gloucester Community Garden group who advised Council they had inspected and investigated the viability of 20 other locations.

Site investigation information provided by the Gloucester Community Garden group is attached at **Appendix 4**.

Gloucester Community Garden design

The survey provided opportunity for participants to provide feedback and suggestions to the community group for plants, vegetables and to be involved in the group. This information is available to view in the Submission Data at **Appendix 1**.



Summary

From the feedback received during the consultation period, most responses received are in support for the community garden and the proposed location.

This information is provided to assist in making an informed decision when considering whether Council supports the Gloucester Community Garden project on the proposed site location.

What's next?

The engagement data contained in this report will be used to inform key staff and management on the outcomes of the consultation for the proposed Gloucester Community Garden.

This feedback will be considered, along with other factors in making an informed decision.

A copy of this report will be made publicly available on Council's website.

Appendices

[Appendix 1: Survey data](#)

[Appendix 2: Submission 1](#)

[Appendix 3: Submission 2](#)

[Appendix 4: Preliminary site investigations](#)



Appendix 1

Submission data



Do you support a community garden in Gloucester?	If you answered 'No' to the garden, please provide a reason below	Do you support the proposed location of the Gloucester Community Garden?	If you answered 'No' for the location, please provide a reason below	Do you have any suggestions for the design of the garden?	Do you have any suggestions on what to grow in the garden?
Yes		Yes			
Yes		Yes			
Yes		Yes		No	Fruit trees
Yes		Yes		Looks fine and will create a special garden social hub for the Gloucester community	Herbs, the usual ones but also less well known one chocolate mint, Vietnamese mint and the different types of basil. Again the usual types of vegetables in season but also the less common ones so people can taste them and learn how to Cucamelons, the different types of sorrels, fingerlimes, oca, Jerusalem artichokes.
Yes		Yes			
Yes		No	This is a nice open space where people walk with their friends. These types of activities have historically failed in Gloucester, leaving behind a mess which has to be remedied.		
Yes		No	The location is near the RV dump site where caravans can discharge their black water and there are spills. I play croquet and see this happening. The area I feel will become untidy with sheds and wicking beds deteriorating over time. I understand water will be needed and who pays for that? Is that also a donation! The garden is just in the wrong space. I hope it works and maybe I can have a carrot or two.	The design of the garden looks ok. But how about moving to King Edward Park a great spot near the river with sheds water and toilet. Wicking baskets will still have the level required to work the beds. Plenty of parking and no RV Dump site.	Seasonal rotation of vegetables. Citrus trees are always great.
Yes		Yes			
Yes		Yes			
Yes		Yes			
Yes		Yes			
Yes		Yes			
Yes		Yes		No. Whatever is suggested by the experts. Perhaps some edible bushfood ?	I am not a gardener so ditto the above. I think it's a great idea! Community inclusion for all ages.
Yes		No	This proposed site will destroy a tranquil area. I am not against a community garden but surely a better area can be found in such a large place	No	
Yes		Yes			
Yes		Yes			Veggies 🍆
Yes		No	It will be an eye sore in a beautiful park when things start to die off especially in the middle of the playing fields why not down the river out in the open just right for vandals and others to help themselves	To close to the dump it would do you all good to watch what goes on there water is emptied anywhere	No
Yes		Yes			
Yes		Yes			
Yes		Yes		It looks great	Lots of edible plants and bee friendly flowers
Yes		Yes			
Yes		Yes			
No	Run by the same people that ran the tucker patch, its an unsustainable model as is. That funding could support greater more sustainable causes	No	It will end up an eyesore in a prime location. It would be best suited to be placed near the high school and nursing home providing programs for ag students and elderly alike	No	No
Yes		Yes			Seasonal fruit and vegetables as well as bird and bee attracting plants
Yes		Yes		No I hope it happens	Things that don't cost a lot so if taken not a problem
Yes		Yes			
Yes		Yes			
Yes	Great idea - provided it has continuing energy past the early days	Yes	It must be tidy at all times and look inviting.	No	No
Yes		Yes		The people involved seem to have the community at heart.	Yes. TARRAGON.
Yes		Yes		Raised garden beds for less active people.	Herbs and a wide selection of edible vegetables. Also edible blossoms to inform the public which ones to grow.
Yes		Yes			
Yes		Yes			
Yes		Yes		I think the design is perfect.	Vegetables that are staples.
Yes		Yes			
Yes		Yes			
Yes		Yes			

No	There was a community garden out on cemetery road and it ended up a total mess and we don't need that in our park area	No	Park is for recitation area and sports. When there is a swimming carnival on that area is needed for parking	No	Backyard are for gardens
Yes		Yes			Fruit and veg that are known to grow well here.
Yes		Yes			
Yes		Yes			
Yes		No	This area is entirely wrong for a community garden. It is squeezed between the dump point, croquet courts, tennis courts and swimming pool! This makes no sense at all! This area is needed for parking during events at the tennis club, swimming club and croquet club. There are many other suitable areas in our spacious park that could be used. Please use some common sense!		
Yes		No			
Yes		Yes			
Yes		Yes			Any type of veggies ...
Yes		Yes		Design looks good, as the garden gets going, remain open to adaptation based on what nature tells you	Hopefully the gardeners will try out all kinds of edibles and gradually find those that do best over the year, as well as when things aren't so easy e.g. with drought. It could go a long way to improving food security for people struggling to afford healthy food
Yes		No	Too close to dump point when caravans need room. Aesthetically I think it is the wrong spot. Plenty of room over near the river in the park area that can be closed off at night from traffic. More room for gardens in that area.	Design is fine	
Yes		Yes		It is difficult to see all the details in this image. In addition to the worm farm, a compost bay should be included in the design. Good soil will be crucial in a contained gardening system such as wicking beds. Also, ensure there is space for delivery vehicles and parking. There are a few other facilities in the area and it could get crowded. Folk in Gloucester are not familiar driving in congested conditions. Good signage and delineation of different areas will help.	Vegetables that people enjoy eating, plants that are suited to the area, a few really good shade trees, and perennial veges, and any veges that can be expensive to buy at the shops. Shade trees are important. They'll provide protection against frosts and the harsh summer sun. No veges need full sun all day.
Yes		Yes		No suggestions for the design, but I wonder how one can stop pilfering and destruction of the garden? It should be securely fenced.	Vegetables that can be sold at the markets, and generally sold on a particular day to the community, or sold through a community stall in the Main Street, away from the supermarkets so not to compete.
Yes		Yes			
No	WHY ANOTHER ONE WHEN THE TUCKER PATCH HAS RECENTLY CLOSED	No	TAKING UP CAR PARKING SPACES FOR TENNIS CLUB, FOOT BALL, SWIMMING ETC. ITS A SPORTING COMPLEX NOT A VEGGIE PATCH	MAY BE LET THE VANDELS DECIDE	
Yes		Yes			Seasonal produce.
Yes		Yes		No suggestions, just anything that would make use of sustainable practices.	Lilly pilly if there is space, cucumbers, cherry tomatoes, butternut pumpkin, sweet corn, herbs (rosemary, basil, oregano, etc.) and seasonal flowers if we can.
Yes		Yes		can't read the diagram	vegetables
Yes		Yes			
No	Gloucester has one of the most attractive and beautiful parks in this area and attracts many visitors. The park has always been for recreational purposes only, not commercial activities.	No	This area is often used as an overflow car park for sporting events.		
Yes		Yes	This is a forced response. I need to know more about the site before giving a meaningful answer.	Can't read the detail in the above sketch.	
Yes		Yes		Extend it further to the right to take up more of the grassed area - make it bigger.	Fruit & veg for the community markets etc.
Yes		Yes			Veggies
Yes		No	The area allotted was supposed to be a sporting complex the area for the garden will take up car parking for tennis tournaments that bring a great deal of money to Gloucester and croquet tournaments also the swimming carnivals, I think the park in ravenshaw st would be a more suitable spot for it.		
Yes		Yes			Organic plants that can bring forth seeds to share widely in the community.
Yes		Yes			
Yes		Yes			

Yes		No	Will impact parking for Tennis Club, Croquet Club and Swimming pool, particularly on special event days such as Gala Days. I believe a Plan of Management for the whole park needs to be established as previously undertaken (20 year plan adopted by Gloucester Shire Council in 1995), otherwise there will be an ad hoc approach to development on what is currently a really well presented active and passive recreation area.	No - although I think that the rabbit problem currently being experienced in the park will probably impact the design.	Herbs, vegetables, fruits
Yes		Yes		I support the existing design.	
Yes		Yes			
Yes		No	The proposed location will reduce the parking space regularly used for gala days by a number of sporting groups. Vandalism of the area is of concern -- will the proposed fencing be high enough to deter vandals? Who will be paying for the upkeep of the space, eg water use? Will the area be leased to the group or free-of-charge (which goes against the 'rules' for other users on the park)? There needs to be a Park Plan put in place so that all interested parties have an opportunity for input into proposed additions to the space.		
Yes		Yes			
Yes		Yes			
Yes		No	Should not be in District Park there is enough going on in this area		
Yes		No	I think they should be looking at the old Farley gates cricket field. It is too dangerous to play cricket there now. Take away the fence & make it into a car park & community garden. It would benefit Netball, Tennis, Soccer, Little Athletics & Rugby league with more car parks for when they have events.		
Yes		Yes			
Yes		Yes		No	Veggies & fruit trees
Yes		Yes		No. I trust the people organising the hard to know what's required. They have the right experience and knowledge	They have great ideas that I support
Yes		No	To close to a sewage dumping site for caravans. If there is any leakage or accidental leakage from sewage dump point and vegetables or fruit can't be consumed. No security or ability to stop anyone entering at any time. Issues with what to do and where to store chemicals and tools. No place for collection and storage of water for drought conditions. If this community garden folds then we are left with a eye sore in high traffic area with the caravan park nearby. Which will come back to the ratepayer to clean up.	Not to have it in its current location.	Nothing edible at that site.
Yes		Yes		It looks a bit small to me for 50 gardeners.(?) I don't mind where you put it but given the size of the park why choose to squeeze it into such a tiny space? Will parking be a problem given that the pool, croquet club, tennis club, and dumping vehicles will all be using the vicinity, albeit at different times?	Sorry, I'm not a gardener. I am a supporter in spirit and by donation. (I struggle with pot plants.) If I can be of use in some other way let me know. I don't weed either.
Yes		Yes		Incorporate Aboriginal art, sculpture and signs in local indigenous language. Also 3D/relief installation for blind people saying what is there.	Native fruit trees as well as ornamental fruit trees. Cut and pick vegetables. Herbs. Indigenous plants to the area.
Yes		No	To close to sewage collection point which can overflow and get stinky. Also to small an area for the community garden when people want to visit and park nearby when parking can be crowded by tennis, pool and croquet patrons.	Place near Boundary Road.	vegetables of various sorts
Yes		No	I think proposed area is too small to cater for up to 50 gardeners and their vehicles. Also, access road for caravan dump site is often inundated with water.	No	No
Yes		Yes			
Yes		No	not a suitable area, must be many other more suitable, like in the riverbank park area. it is too small, has dozens of rabbits using that area nightly and is very wet, especially after rain and it stay wet for quite a long time. please find another more suitable area ?		
Yes		Yes		Create a specific seed saving area. If you try to grow seed in general gardens they can hold up production and harder to manage	

				As a teacher at Gloucester Public School, we use the laneway between the tennis courts and the croquet club when taking our students to swimming for sport. This is the safest route for us as it takes our groups of up to 100+ students away from the roadway. The area next to the road is often rough or muddy and difficult for us to navigate large numbers of students with caravans and other vehicles close to the road. I am worried that we may lose this access with the introduction of Stage Two of this project. Could a wide concrete pathway (pedestrian and bikes) be constructed around the croquet club (say from the dump point around to the park near Farley Gates) to ensure the safety of our students off the road. I'm sure this would also be a valuable addition to our visitors to the caravan park as well, as people often walk on the road due to the lack of footpaths in that area.	
Yes		Yes			
Yes		Yes			
Yes		Yes		I do not have a design however - I would love for the group/Council to ensure that a wide variety of people are involved regularly, so it is truly inclusive, all ages & abilities, involved on a regular continuing basis, employed, unemployed, youth (13 to 18, young adults 18 to 25), sporting clubs, homeless, school children from kindy through high school, families etc to ensure continued respect, pride & ownership of the project. Services (eg, BWNG, Catholic Care - Youth, School, Indigenous Cultural sharing (inclusion of some Bush Tucker component), TAFE Outreach) could be invited to run educational projects for cooking growing etc. Regular open days & invitations (letter drops), for all community members to be involved.	
Yes		No	It is a public park land, not a commercial garden .		
Yes		No	This is a under utilized part of the park. Surely there is a better location. Not in such a public place	No	
Yes		Yes		Vegetable	
No	Eye sore in a beautiful park when things start dieing why not utilise King George park if raised gardens are going to be used it has a toilet shed and close to water and a small playground for the children what more could you ask for	No	Not a good look for a beautiful park better places in town see above		
Yes		Yes			
Yes		Yes			
Yes		No	The location becomes waterlogged and as most participants will drive to it, it will become a quagmire. It is in an already busy area of the park. The inevitable theft of plants/produce will result in a higher, visually obtrusive exclusion fence having to be erected later.	It looks like a well thought out design Move it away from this area of the park, to another under-developed park, or contact the Gloucester Showground to see if they would accommodate it (it has large areas of flat, alluvial land, is already fenced and has plenty of fertiliser)	
Yes	Only concern is not to follow The Tucker Patch model	Yes		I endorse growing seasonal vegetables as would already be planned by the committee Use the well prepared soil from the defunct Tucker Patch	
Yes		No	the location is convenient for most of the training members of the group, not necessarily the community as a whole. Major concerns on the close proximity to the dump plant and easy access with little security measures. If the garden successfully grows, space restrictions then come into play. I am in full support of a community garden but not this location. The original Tucker Patch site seemed to be an ideal location for general community access and plenty of space to expand. With local schools being more involved and interested in growing gardens, it would be a true community project if schools could be involved. There's a perfect space between the high school and the new nursing home....the school could adapt it as part of their classes and it could be an invaluable opportunity to involve the nursing home residents...whether that may be for active advice/involvement or watching on from a therapeutic point of view.		
Yes		Yes	Groups run and largely populated by retirees often end up	What a great opportunity to involve local experts to start off the garden right! Invite the local nurseries, seed savers group, local providers to help. Involving outside advice and consult will also help avoid infighting group decision making. Approach a large nursery/garden supplier to give advice and invite them to come on board as a further sponsorship opportunity.	
Yes		Yes			

No	Everyone has their own garden to take care of.	No	Too near our sporting venues.	No	No
No	there bis the sight you have already choosen applicable for elderly who dont drive or are unable to get there this	No	because you will ahead anyway regardless of any objection that is put forward the sight has been choosen and no one knew a thing about the community garden project till it appeared on the front of the advocate and like all councils a waste of money other things need atten tion like street signs the footpaths that the motorised scooters can safely drive on gutters the rubbish cleaned away from them I could go on about other thinks council need to attend to but enough for now rabbits will enjoy the vegies	No	built up as older people cannot bend hope all ohs, issues are covered
No	This concept had previously been established off Cemetery Road, failed and is now abandoned.	No	Wrong location and towards end of harvest period, could become an eyesore. Flower gardens ok but not vegetables		
No	They tried a community garden at Cemetery Rd ended in disaster. There are plenty of other places NO our sporting park	No	They is a park at the end on Ravenshaw St or near the Shire Depo Church St south	No It will end up like Cemetery Rd garden	No
No	Poor choice of location. Most housing in Gloucester has back yards, maybe the enthusiastic drivers of this project could help establish nome gardens. I see it being a negative influence on our beautiful well kept park. Perhaps a more appropriate location would be an advantage. Personally I see it becoming an eye sore in middle of park and using an area often filled with overflow parking from the swimming pool or tennis courts. What happened to the Tucker Patch with huge economical investment, grants etc?	Yes	Why spoil an already beautiful park? A no brainer	No	No
Yes		Yes			
Yes		Yes			
Yes		Yes			
Yes		Yes		Looks great to me	Veg, fruit, perennial and annual, bee flowers, cut flowers, plants for craft ie dye, pressing, weaving.
Yes		Yes			
Yes		Yes			Vegetables fruit bush tucker
Yes		Yes			
Yes		Yes		No	Herbs , seasonal veggies, bush tucker and other native plants for teas
Yes		Yes		Not really	Stuff to buy
Yes		Yes		No	Beetroot and ginger
Yes		Yes		No	No
Yes		Yes		Great idea. My suggestion get the DA done soon please	As a local vigneron, what about a some grape vines, both table and wine varieties.....
Yes		No	This is not the place for such a garden. Public space is for all. Who will control the appearance? The park is Gloucester's show piece, we don't need a mess.		

				The garden design and positioning on the site, as per the published design, makes good sense. There has been concern expressed that the site will limit parking access for sporting/leisure activities in the adjoining area. From knowledge of the people involved in the Community Garden project, it is clear they are more than willing to work with their neighbours, for example the Croquet Club, to arrange and provide space for additional temporary parking for larger Club events.	The organising group are knowledgeable and we can rely on their experience to see an interesting and varied Community Garden develop.
Yes		Yes			
Yes		Yes		May be something to honour our nation of all peoples	Australian natives
			Our parks are beautiful areas, I believe this is the wrong place for the community garden, there is the chance that the gardens will look untidy and blemish our beautiful park		
Yes		No			
Yes		Yes			Asian vegetables.
Yes		Yes			
Yes		Yes		Water feature but growing water edible plants	
Yes		Yes			
Yes		No	Too close to human waste dumping site, we have so many areas that could be better utilized as a community garden	Love the idea of a community garden ... however after showing some interest in being involved, and after asking too many questions, it seems not all people within our community or their ideas are welcome ... it would be great to involve ALL members of the community, not just those who are retired, have the same political views or ideas .	Produce to give away to schools for recess / lunch + cooking activities .
Yes		Yes			
No	It will be a absolute eye sore in a few years when these people are too old to continue gardening and no one will step up.	Yes	No ,there are plenty of other places more suitable than this for this garden. The park location chosen is no place for a community garden.no	No	Noonan Harwood
Yes		No	It is the worst possible spot. It will ruin the aspect of the beautiful garden opposite , take up much needed parking for the pool and the garden and last community garden near the cemetery has still not been cleaned up now it is not being used	It needs to be relocated to somewhere else	I am unsure how it is to be run is it for individual allotments or communal . This will dictate what it will be used for
Yes		No	Vegetable gardens are wonderful and look lovely whilst growing; they then become untidy and messy when dying off and could easily become an eyesore in our beautiful park. I believe an ideal alternative for the proposed garden would be King George V Park. This park has amenities, is a larger area and less likely to be vandalized.	No.	No.
Yes		Yes		Longer wicking beds can be built using round-back slabs from timbermills. We are looking at doing this in Tinonee for our fledgling community garden proposal. We have two such beds on our own property and the larger one (14m/1m) is automatically fed from the rainwater tank which is fed by the adjacent shed/garage. My experience has shown that a wicking bed can be supplied year-round, via a small 2500 litre tank and float-valve. Each square metre of bed needs 10 square metres of catchment.	
Yes		Yes			
No	It is hard to keep up the interest in a project of this nature. The people responsible for the upkeep may develop health issues, may wish to travel extensively and may find the weather detrimental to their ongoing participation.	No	This is a very attractive area now. It would be hard for the garden to remain tidy when the initial interest wears off. The gardeners involved may not have the time or the stamina to keep the venture going to a satisfactory level. The site is too close to the caravan dump site.		

118 Yes
12 No
130 total

34 do not support location
96 support location
130 total responses

Appendix 2

Submission 1



**Petition to Midcoast Council
By Gloucester Croquet Club**

**TO MOVE SITE OF PROPOSED COMMUNITY GARDEN FROM
SPORTS AREA OF GLOUCESTER PARK**

The proposed Community Garden Site is already well utilised by many casual users of the park. Many people walk through this area in groups as part of an exercise program. Also people walking dogs use the area for play.

The area is aesthetically pleasing to the eye at the moment being next to the Memorial Park. This section of the park is often used for Weddings and Funerals as it is convenient for all and it is very attractive.

The sporting groups surrounding the proposed area for the community garden use this area for parking when the need arises.

1. The Tennis Club holds a number of competitions during the year, with players coming from all parts of the State.
2. The Swimming Pool is used for carnivals during the summer which bring crowds of spectators as well as participants. The Swimming Club operates every Thursday night during summer.
3. The Croquet Club also holds a number of zone competitions during the year. The area nominated is then used for parking by participants from all over the Mid North Coast.
4. This area proposed for the community garden is right in the centre of the sports section set aside many years ago by Gloucester Council with netball courts, sports ovals and the recreation hall nearby.
5. It might be noted that the Croquet Club was not allowed to purchase a large water tank, and was also told their storage shed had to be out of sight behind the club building. (No garden sheds allowed!)
6. Nevertheless, the proposal to form a community garden has merit - all that is required is another, more appropriate site, not necessarily in Gloucester District Park.

A site which has many advantages has been suggested away from the Gloucester District Park.

The area is King George V Memorial Park on the Northern end of Ravenshaw Street. This park is underutilised and has plenty of suitable space. It also has a toilet block and a very good shed. It appears to have access to water at the side of the existing shed. There are a number of

covered seats which would be a bonus for the Garden members for tea breaks etc.

Other sites to consider are 1. The lower section below the overflow area from the caravan park, on the western side of the Swimming Pool.

2. The large area to the south of the caravan park. This is a huge, flat area.

There are many other areas in the park near the river.

KING GEORGE V PARK



Toilet block



Large shed

Shed - Shaded Seating



Open area with full sun

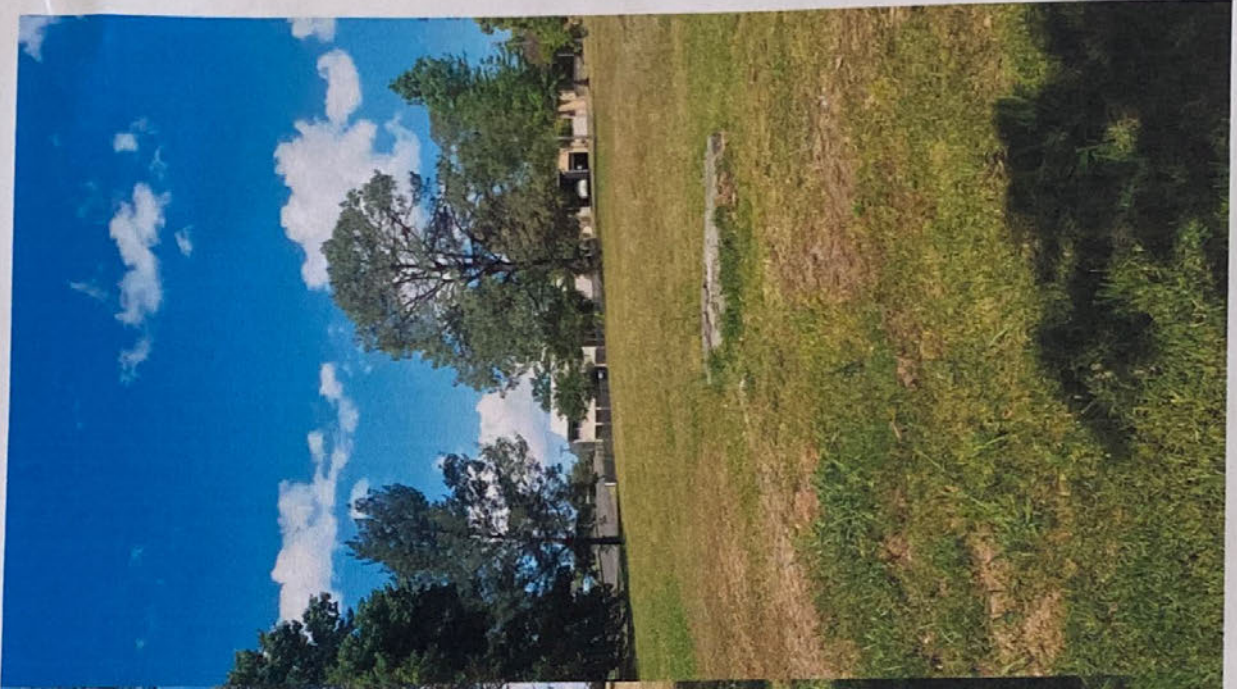

King George V
Park

Petition to Midcoast Council
By Gloucester Croquet Club

TO MOVE SITE OF PROPOSED COMMUNITY GARDEN FROM SPORTS
AREA OF GLOUCESTER PARK

Date	Print Name	Print Address	Signature
5.8.20			
5-8-20			
5 8 2000			
5 8 2000			
5.8.20			
5.8.20			
5-8-21			
6 8. 20			
7-8-20			
2.8.8.20			
11.8.20.			
12.8.20			
12-8-20			
12.8.20			
12.8.20.			
12.8.20			
12.8-2020			
12 8. 20			
12-8-2020			

(19)

0.1

Petition to Midcoast Council
By Gloucester Croquet Club

TO MOVE SITE OF PROPOSED COMMUNITY GARDEN FROM SPORTS
AREA OF GLOUCESTER PARK

Date	Print Name	Print Address	Signature
8/8/2020			
8/8/2020			
8/8/2020			
8/8/2020			
8/8/2020			
9-8-2020			
9/8/20			
9/8/20			
9/8/20			
9/8/20			
10.9.20			
10.9.20			
10-9-20			
10.9.20			
10.9.20			
9.2.20			
9.2.20			
9-9-20			
9.9.20			

Petition to Midcoast Council
By Gloucester Croquet Club

TO MOVE SITE OF PROPOSED COMMUNITY GARDEN FROM SPORTS
AREA OF GLOUCESTER PARK

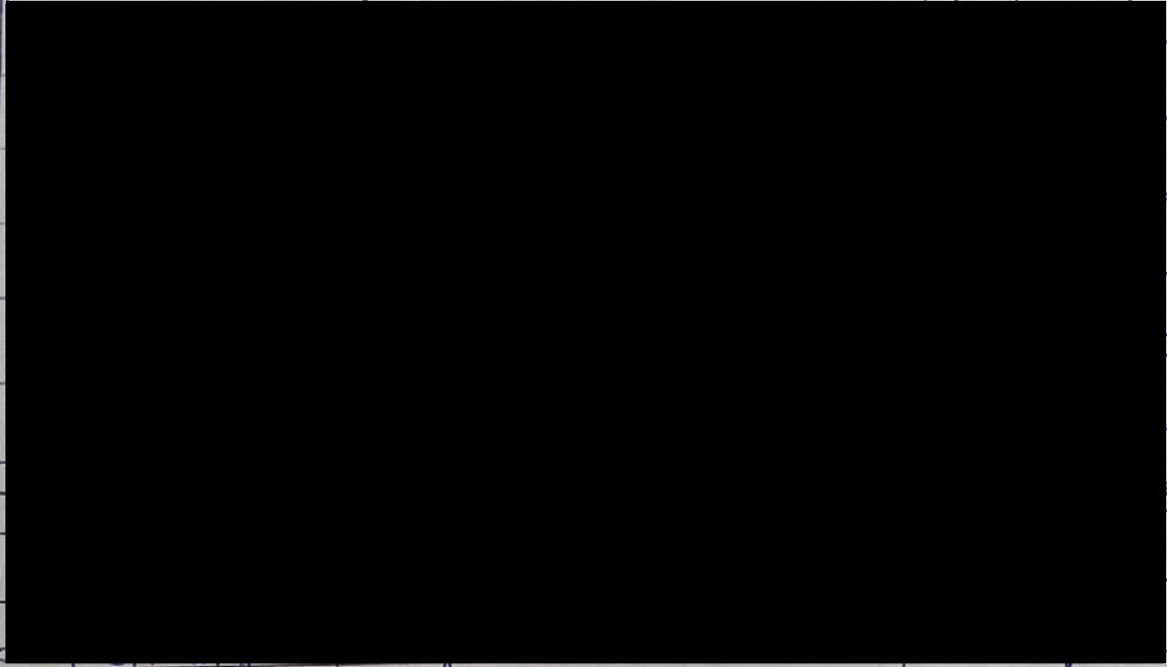
Date	Print Name	Print Address	Signature
6-8-20			
6-8-20			
6-8-20			
15/8/20			
11			
21-8-20			
21. 8. 20			

Petition to Midcoast Council
By Gloucester Croquet Club

TO MOVE SITE OF PROPOSED COMMUNITY GARDEN FROM SPORTS
AREA OF GLOUCESTER PARK

Date	Print Name	Print Address	Signature
5-8-20			
5.8.20			
5.8.20			
5.9.20			
"			
"			
"			
"			
"			
"			
"			
"			
"			
"			
16.8.20			

(15)

Petition to Midcoast Council
By Gloucester Croquet Club

TO MOVE SITE OF PROPOSED COMMUNITY GARDEN FROM SPORTS
AREA OF GLOUCESTER PARK

Date	Print Name	Print Address	Signature
13.8.20	[REDACTED]	[REDACTED]	[REDACTED]
"	[REDACTED]	[REDACTED]	[REDACTED]
"	[REDACTED]	[REDACTED]	[REDACTED]
3	[REDACTED]	[REDACTED]	[REDACTED]

Petition to Midcoast Council
By Gloucester Croquet Club

TO MOVE SITE OF PROPOSED COMMUNITY GARDEN FROM SPORTS
AREA OF GLOUCESTER PARK

Date	Print Name	Print Address	Signature
5/8/20	[REDACTED]	[REDACTED]	[REDACTED]
05-08-20			
5-8-20			
5.8.20			
5.8.20			
5.8.20			
5 8 20			
5.8.2020			

Petition to Midcoast Council
By Gloucester Croquet Club

TO MOVE SITE OF PROPOSED COMMUNITY GARDEN FROM SPORTS
AREA OF GLOUCESTER PARK

Date	Print Name	Print Address	Signature
9-8-20			
9-8-20			
10/8/20			
10-8-20			
10-8-20			
10-8-20			
11-8-20			
14-8-20			
29-8-20			
29-8-20			
1-9-20			
"			
15-10-20			
10 Oct 2020			
16/10/20			

Appendix 3

Submission 2



From: MidCoast Council
Sent: Tuesday, 3 November 2020 1:12 PM
To: MidCoast Council
Subject: General Contact Form Submission



General Contact Form Submission

Question	Response
When to use this form	
Your details	
Title	[REDACTED]
Surname	[REDACTED]
Firstname	[REDACTED]
Which Council region are you located in?	Gloucester region
Your postal Address	[REDACTED]
Contact telephone number(s)	[REDACTED]
Email address	[REDACTED]
How should we contact you if we need to?	Either
How can we help you today?	
What is your request about?	Development / Building
Does your request relate to a specific property? If so, please provide that address below:	Proposed development of a community garden in the Billabong Park, Gloucester
Please provide more information to help us:	The site proposed is in an area adjacent to the Gloucester tennis courts, croquet courts, with nearby basketball courts and opposite to the swimming pool and Hydrotherapy pool Due to the covid virus the area proposed has not been fully

	<p>used for parking by the named clubs as is normally the case, as so many activities have been cancelled this year. It is presently used for emptying bowel waste from caravans in an installed outlet. Normally this area is used for various functions and competitions by the croquet club, tennis club and swimming club,</p>
<p>What would you like us to do ?</p>	<p>We are not against having a community garden in Gloucester but plead with the Council to move the site to a more appropriate place. The St George Park would be ideal, as it is near the river for water to be pumped up to the tank, it has toilets, and a shed which can be used by the community. It is a peaceful place, while the present site would be subject to vandalism as it is right on a park road where much traffic passes by. I can imagine how long vegetables etc would last! One prospective gardener said the site in St George park had a slope, but has the gardens are always built up I don,t see this as a problem.</p>
<p>Upload a picture(s) or document(s) that may help us if you wish:</p>	<p>.</p>
<p>Privacy</p>	

Appendix 4

Preliminary site investigations





GLOUCESTER COMMUNITY GARDEN SITE SEARCHES A

1. **Adjacent to Cricket/MCC Brick bldg.** Ian Jackson's first offer. Pro's—nearby roof for water collection; in District Park, good parking. Con's—narrow/small site (120 m²). Substantial fill needed—waterlogged site. Cricket Club rejected due to vehicle access required.
2. **Opp Cricket/MCC Bldg.** Larger site (240 m²). Pro's—flat, not waterlogged, water access nearby, good parking. Con's—Large trees shade site. Council engineers rejected site.
3. **Fairley Gate field** (Gloucester Croquet Club recommended). Pro's—large flat site, Good drainage, parking on main road. Con's No Water, no shade, Cricket Club vetoed due to their needs.
4. **Citrus Grove** (Gloucester Croquet Club recommended). Pro's—Flat well drained site, parking plentiful. Con's—No water, poor security, Council negative to site.
5. **Behind Pool**, near river. Pro's Large flat site, good parking. Con's—No water, No shade, poor security. Council rejected site (other use)
6. **Billabong Park Nth.** Small site (120 m²). Pro's—Handy site, good street parking. Cons—Subsequently a flying fox erected on the site.
7. **MCC offered site** and our No1 choice. Pro's—Sizeable, flat site, Water access, shady area, good parking, good security, 2 of 3 neighbours OK'd the site. Cons—3rd neighbour very anti the site, but not the garden.

Only this site (and site 8) have access to toilets; an important requirement for volunteers who spend hours on site.



GLoucester COMMUNITY GARDEN SITE SEARCHES B

8— King George V Park— early choice. Pro's—large area, with roof for water, good parking, close to homes for security, lighting. Con's—steep, playground, remote. Rejected by Council.

9— Gloucester Masonic Hall.—Pro's—Flat area, good security, water available. Initial discussions OK, then rejected due to security concerns

10—Christian Fellowship Church—. Pro's—large flat site, access to water, good parking. Our request rejected by Church



GLOUCESTER COMMUNITY GARDEN SITE SEARCHES C

11,12,13 & 14— All private land. All landowners were positive about the Community Garden. 2 of the 4 did not have water or roof area. 1 was earmarked for development and one was used for agistment—all unsuitable therefore.

21.—Uniting Church—Pro's—Large (400 m²) site, flat, 2 sides fenced, water access, good parking. Cons—no shade. The Church rejected us as they have plans for the site in the future. This would have been the best site outside District Park



GLoucester COMMUNITY GARDEN SITE SEARCHES D

- 15—Hay Street Park**—Pro’s—Water access, good parking, shade. Cons—Small area (100 m²), playground, remote, poor security
- 16—Private land (offered by owner)**. Pro’s—large site, water available. Con’s—Land very steep, no parking, poor security, remote
- 17—St Clements Park**—Pro’s—large, flat area. Water available, good parking. Cons— very remote, poor security (site appears abandoned)
- 18—Reichert Park (my wording)** - Pro’s—Large flat area, Parking adequate. Cons—No water, too remote, poor security.
- 19 & 20—Dawson Crescent Nth & Sth**— Pro’s—adequate parking, water in nth park, some shade. Cons—Both steep, obvious drug meet (I found syringes), poor security (both have tiny unsighted frontages), too remote.

Ian Jackson has been consulted about other parks in town (incl Cook Park, Showgrounds, Lions Park north of Gloucester River, Memorial/ANZAC Park) and all were either deemed unsuitable or not available. I approached 5 farmers on the outskirts of town and received a warm & positive welcome. However all declined for one or other reasons to offer an area (wanted for agricultural purposes, no water, too remote, future uses).

In total I have looked at over 30 sites in and around Gloucester and the site offered (site 7) is by far the best and most secure.